

BELL SYSTEM PRACTICES
Station Installation and Maintenance

SECTION C44.651
Issue 1, 8-11-44
AT&T Co Standard

19A SHELF

DESCRIPTION AND INSTALLATION

1. GENERAL

1.01 This section gives information relative to the description and installation of a shelf designed for mounting a coin collector and associated telephone directory.

1.02 The shelf provides a means of improving installations at stations where space or other considerations make the use of a booth impracticable. Indoor locations which are relatively quiet and provide adequate light for dialing, etc., are suitable for installations of the shelf.

2. DESCRIPTION

2.01 The new shelf, coded 19A, combines a coin collector mounting, a compartment for a conveniently suspended directory and a wide shelf for writing and for placing handbags, parcels, etc., while using the telephone. The shelf is of gumwood construction with the standard walnut finish and its overall dimensions including mounting backboard, are 28-9/16" wide, 18-15/16" high and 16-9/16" deep. The mounting for the coin collector forms an integral part of the structure and places the coin collector at an angle of 30° to the wall. The subscriber set for the ringer is stored at the rear of the directory compartment back of a removable partition or cover. Sound openings are provided to permit hearing the ringing signal.

2.02 The shelves may be placed singly or in groups with the directory compartments forming partitions between adjacent stations, thereby affording some degree of privacy as compared to sets mounted openly on a wall. The shelf is also adapted to corner mounting with preference given to mounting with the narrow end rather than the directory compartment in the corner.

2.03 The 19A shelf is illustrated in Fig. 1.

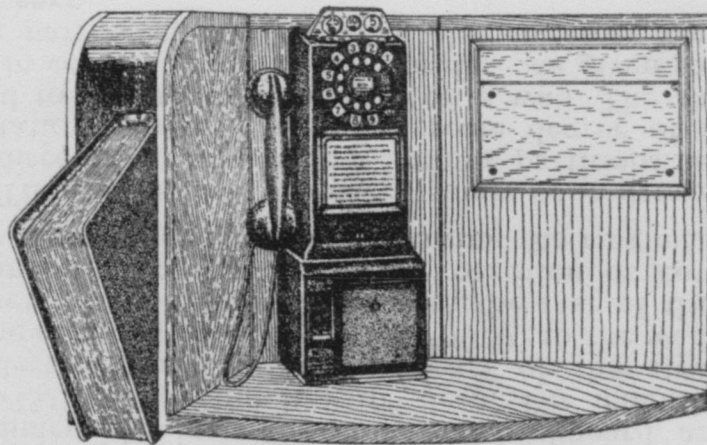

Fig. 1—19A Shelf

2.04 As shown in Fig. 1 the telephone directory hangs in a standard hard cover binder. The directory compartment accommodates a 2-1/2" binder capable of containing the largest directory in common use. In some areas directory needs may require that two smaller directories be enclosed in a single binder. The compartment is sufficiently recessed to permit the directory to hang freely and a felt covered bumper dampens the impact when the book is released.

2.05 A wooden ledge is provided beneath the coin collector mounting to prevent coins, etc., from sliding under the coin collector from whence recovery would be difficult. A wooden instruction card frame similar to the KS-6486 card frame used in telephone booths but opening at the top is furnished with the shelf. Certain of the shelf mounting screws are concealed by the card frame. A wooden backboard is also furnished with each shelf to facilitate installing on any type of wall.

2.06 Because of noise conditions inherent to open type installations, the use of the hand set type coin collector and anti-sidetone circuit with this mounting at public telephone stations is recommended. If a hand set coin collector is not available other coin collectors may of course be used. As indicated before, this shelf is generally not installed at public telephone stations where reasonably adequate provisions for a booth installation can be made.

3. SUPPLIES

3.01 Numbers of piece parts of the 19A shelf which may require replacement and supplies required for installation are listed below.

Item	Description
Assembly, Card Frame:	P-480638. Wood card frame for instruction cards with removable upper section. Includes glass and wiring nail to hold top section in place.
Anchor:	5/16" x 2-1/4" Hammer Drive Anchor. Used to attach backboard to unfinished masonry walls. 5/16" x 2-3/4" Hammer Drive Anchor. Used to attach backboard to finished masonry walls. 1/4" x 1" Machine Screw Anchor. Used to attach backboard to masonry walls.
Backboard:	P-480578. Walnut finished wood backboard with stile ends. Equipped with 7 tee nuts for attaching shelf.
Bolt, Toggle:	1/4" x 4" R.H. Toggle Bolt. Used to attach backboard to hollow tile and glazed tile over metal lath walls.
Chain:	No. 35 Bronze Sash Chain, 1-15/16" Long. Used for suspending directory binder.
Covers:	P-460661. Wood cover used as partition at rear of directory cabinet to conceal subscriber set. P-460664. Wood cover for closing upper section of recess in directory compartment.
Eyebolt:	P-480565. 1-3/4" .190-32 Eyebolt with bronze finish. Used to anchor sash chain to directory compartment.
Frame, Card:	P-372883. Removable upper section of P-480638 assembly.
Glass:	P-372884. Glass 10-1/2" x 7" for card frame.
Nut:	P-218749. Nut used with P-480565 Eyebolt.

- Pad:** **P-460660.** Felt pad, T.R. Brawley No. 221 or approved equivalent. Used as bumper in directory compartment recess.
- Screws:** **P-210252.** 1/4" x 1-1/8"-20 F.H. Machine Screw with 289 Finish. Used to attach coin collector to mounting.
No. 8 F.H. 5/8" Bright Wood Screw. Used to attach card frame to shelf.
No. 8 R.H. 1-1/4" Wood Screw. Used to attach P-460661 cover.
No. 14 F.H. 1-1/4" Bright Wood Screw.
No. 14 F.H. 1-3/4" Bright Wood Screw.
No. 14 F.H. 2-1/2" Bright Wood Screw.
No. 14 F.H. 3" Bright Wood Screw.
1/4" x 1-1/2"-20 F.H. Bright Machine Screw.
1/4" x 2"-20 F.H. Bright Machine Screw.
1/4" x 3"-20 F.H. Bright Machine Screw.
- Subscriber Set:** 684 Type Subscriber Set.
- Washers:** **P-284193.** Used with P-480565 Eyebolt.
No. 10 x 7/64" x 1/16" Non-Tangling Lock Washer. Used under P-218749 Nut.

4. LOCATING AND MOUNTING

4.01 Locate shelf as specified on the service order or attachment thereto. If location specified conflicts with any of the requirements outlined herein, notify your supervisor and do not start installation unless instructed to do so.

(a) Location selected shall be easily accessible to the public and approach to the shelf free from hazards such as nearby staircase leading down, trap door, floor in poor condition, etc.

(b) Location shall also be sufficiently remote from radiators, steam pipes, registers, etc., to prevent probable damage to shelf or apparatus from either excessive heat or water. These mountings shall be located where they will not be exposed to the action of the elements.

(c) Where dial type coin collectors are to be installed, lighting should be adequate for dialing at all times.

4.02 Locate the shelves singly or in groups along walls as indicated in Fig. 2.

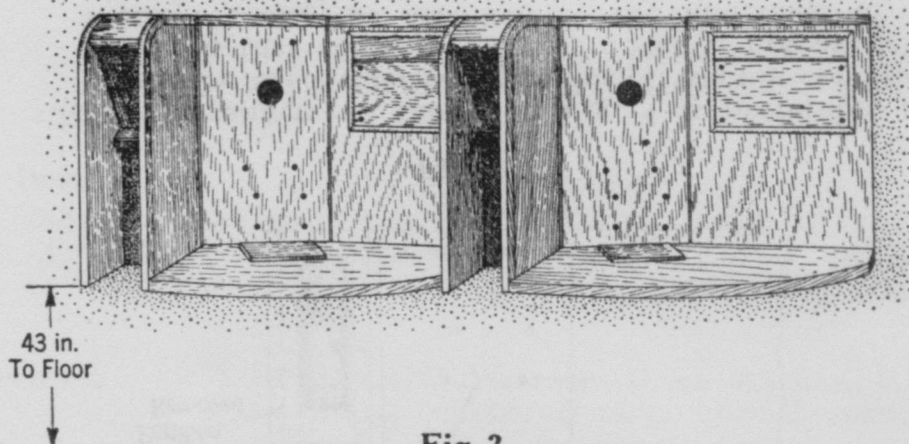

Fig. 2

4.03 Where corner mounting is desired, place shelf so that the narrow end preferably is in the corner as shown in Fig. 3.

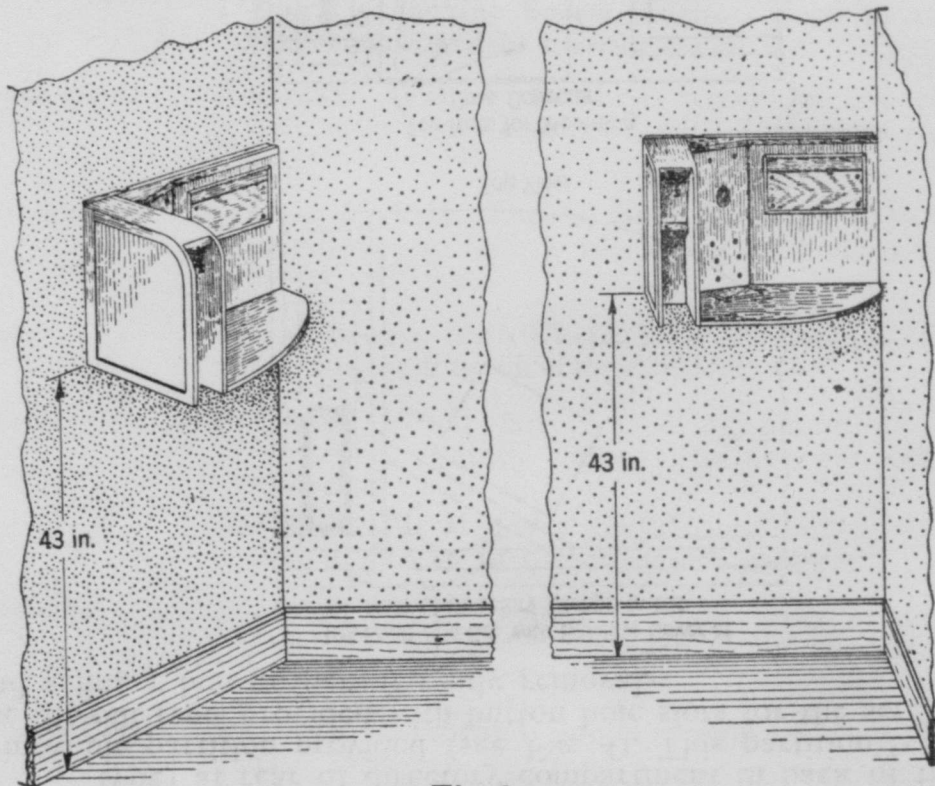

Fig. 3

4.04 Where a lower mounting than indicated in Figs. 2 and 3 is desired in special cases at Army and Navy hospitals, etc., the wood seat bracket used in telephone booths or similar

approved support should be placed under the shelf to guard against possible damage to the shelf should some one use it as a seat.

4.05 Store subscriber set with bakelite cover (684 or 584 type) at rear of directory compartment in back of the removable partition provided (see Fig. 4). This partition is of the lift-out type, provided with button hole slots for the screws and a finger hole to permit ready removal.

19A Shelf and Set with Bakelite Cover at
Rear of Directory Compartment

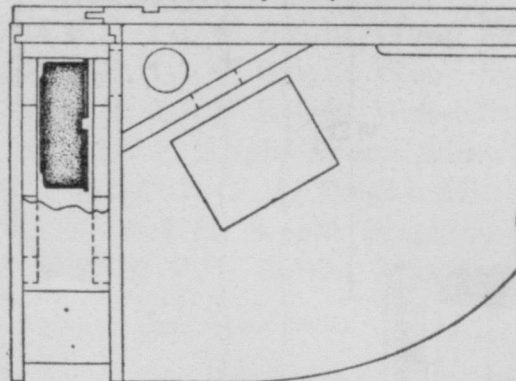

Top View

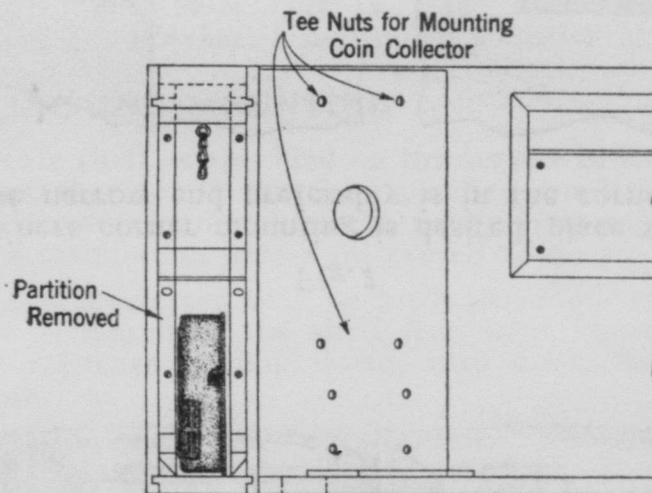

Front View

Fig. 4

Note: Arrangement shown in Fig. 4 is preferable and should be used whenever possible. If supply conditions are such that set with bakelite cover is not available, metal set may be attached to the underside of the shelf at the rear.

4.06 Use backboard furnished to mount shelf on wall surfaces. Attach the backboard to the various wall surfaces with at least six fasteners of the type normally used to mount backboards for coin collectors on walls.

4.07 When mounting on plaster over wood surfaces, locate mounting holes in backboard so that wood screws will enter at least two studs. Place three screws in each stud, spaced equally, one above the other. Countersink flat head screws in backboard.

4.08 Where anchoring devices such as hammer drive and machine screw anchors, toggle bolts, etc., are used for mounting the backboard, locate mounting holes horizontally along the top and bottom of the backboard. Place 7/16" x 1" round washer under flange of hammer drive anchors and place 5/16" x 3/4" washer under head of toggle bolts. Counterbore or countersink backboard so that head of fastener will be flush with backboard (not over 1/4" deep).

4.09 Attach shelf to backboard with the seven 1/4" x 1-1/2"-20 F.H. Machine Screws furnished with the shelf and attach the coin collector to the mounting with the eight P-210252 F.H. Machine Screws furnished for this purpose.

4.10 To place instruction card, remove upper section of card frame by sliding the top molding in an upward direction along the back of the shelf. Remove glass, insert card, and then replace glass and upper section of card frame.

4.11 Place directory in binder and suspend binder from short piece of chain attached to eyebolt in directory compartment.

5. WIRING

5.01 Where wire run is above the top of the shelf bring wires down through the slot at the rear of the backboard to the bottom of the backboard and up through the 2" hole in the underside of the shelf behind the coin collector mounting. Another 2" hole is provided in the coin collector mounting to permit bringing wires into the coin collector. A third 2" hole is provided in the side of the directory compartment adjacent to the coin collector mounting for wiring to the subscriber set. Where wire run is below the shelf, run wires directly to the 2" hole in the underside of the shelf.

5.02 In terminating wires at the subscriber set leave sufficient slack (approximately 18") at the rear of the directory compartment to permit removing the set for maintenance purposes.

C44.651

Page 7
7 Pages

19A SHELF
DESCRIPTION AND INSTALLATION